

BS-67D

21671B-ALM

INDUSTRIAL FINE WIRE STAPLER
GRAPADORA INDUSTRIAL DE ALAMBRE FINO
AGRAFEUSE INDUSTRIELLE À AGRAFES FINES

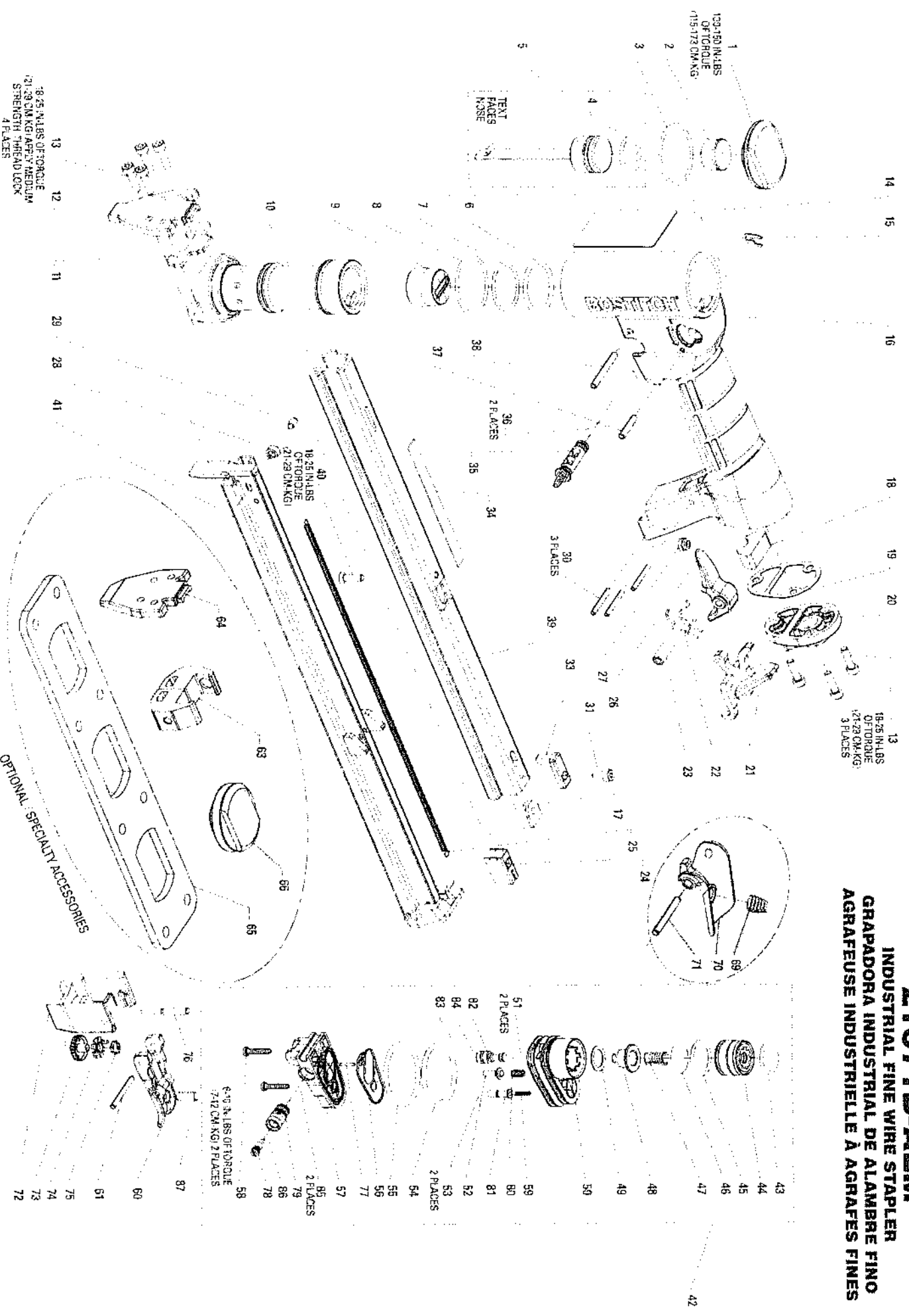

139-160 IN. LBS.
OF TORQUE
(115-172 CM. KG.)

TEXT
FACES
K35E

18.25 IN. LBS. OF TORQUE
(21-29 CM. KG.) APPLY MEDIUM
STRENGTH THREAD LOCK
4 PLACES

18.25 IN. LBS.
OF TORQUE
(21-29 CM. KG.)

OPTIONAL SPECIALTY ACCESSORIES

IP1245-TREVA 02/07
TO BE USED WITH PARTS LIST IP1245-2 AND OPERATION AND MAINTENANCE MANUAL 174325.